

## SPL 3D™ Cell Floater Dish (#26035/26060/26100)

### 1. Description

SPL Life Sciences provides a new culture vessel that provides an optimized environment for 3D cell culture. The culture vessel, which is effective for the formation of spheroids of animal cells, does not require any special incubation techniques, and thus 3D cell culture can easily be implemented in the same way as conventional 2D culture.

### 2. Features

- ❖ Low cell attachment
- ❖ Shelf life: 3 years at 25°C

### 3. Product Range

Cat. No.	Dish Style (mm)	Internal Dimension (mm)	Growth Area (cm <sup>2</sup> )	Working Volume (ml)	External Grip	Packaging
26035	35.00 x 10.00	35.00 x 9.60	9.40	3.00	+	10 / 20
26060	60.00 x 15.00	52.80 x 12.80	21.50	5.00	+	10 / 20
26100	90.00 x 15.00	85.73 x 12.60	57.50	12.50	-	10 / 10

### 4. Certification

SPL Life Sciences hereby certifies that the product identified above, inspected to be in compliance with product quality specification and requirements as documented in our ISO 9001:2015 Quality Management System (K-QA-Q031478) in Korea.

### 5. Specifications & Technical Drawing

(1) Cell Floater Dish Ø 35 (# 26035)

- Specifications

Dimensions		Material (Resin)	Packaging
Lid	Dish		
Diameter: 40.30 mm Height: 6.00 mm	Inner Diameter: 35.00 mm Inner Height: 9.60 mm Volume/Dish: 3.00 ml Growth Area: 9.40 cm <sup>2</sup>	Crystal-grade polystyrene (PS)	<ul style="list-style-type: none"> <li>▪ Pieces/Sleeve: 10</li> <li>▪ Pieces/Case: 20</li> </ul>

- Technical Drawing

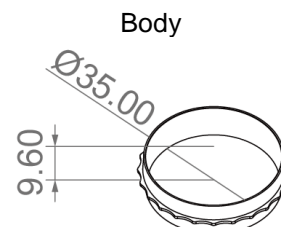
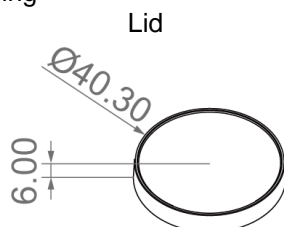

(2) Cell Floater Dish Ø 60 (# 26060)

- Specifications

Dimensions		Material (Resin)	Packaging
Lid	Dish		
Diameter: 58.00 mm Height: 8.50 mm	Inner Diameter: 52.80 mm Inner Height: 12.80 mm Volume/Dish: 5.00 ml Growth Area: 21.50 cm <sup>2</sup>	Crystal-grade polystyrene (PS)	<ul style="list-style-type: none"> <li>• Pieces/Sleeve: 10</li> <li>• Pieces/Case: 20</li> </ul>

- Technical Drawing



(3) Cell Floater Dish Ø 90 (# 26100)

- Specifications

Dimensions		Material (Resin)	Packaging
Lid	Dish		
Diameter: 92.43 mm Height: 8.76 mm	Inner Diameter: 85.73 mm Inner Height: 12.60 mm Volume/Dish: 12.50 ml Growth Area: 57.50 cm <sup>2</sup>	Crystal-grade polystyrene (PS)	<ul style="list-style-type: none"> <li>• Pieces/Sleeve: 10</li> <li>• Pieces/Case: 500</li> </ul>

- Technical Drawing



12086 Miramar Pkwy  
 Miramar, Florida, 33025, USA  
 +1 (305) 600-0444  
 info@prolabcorp.com  
 www.prolabcorp.com